

# The Guest House at Graceland

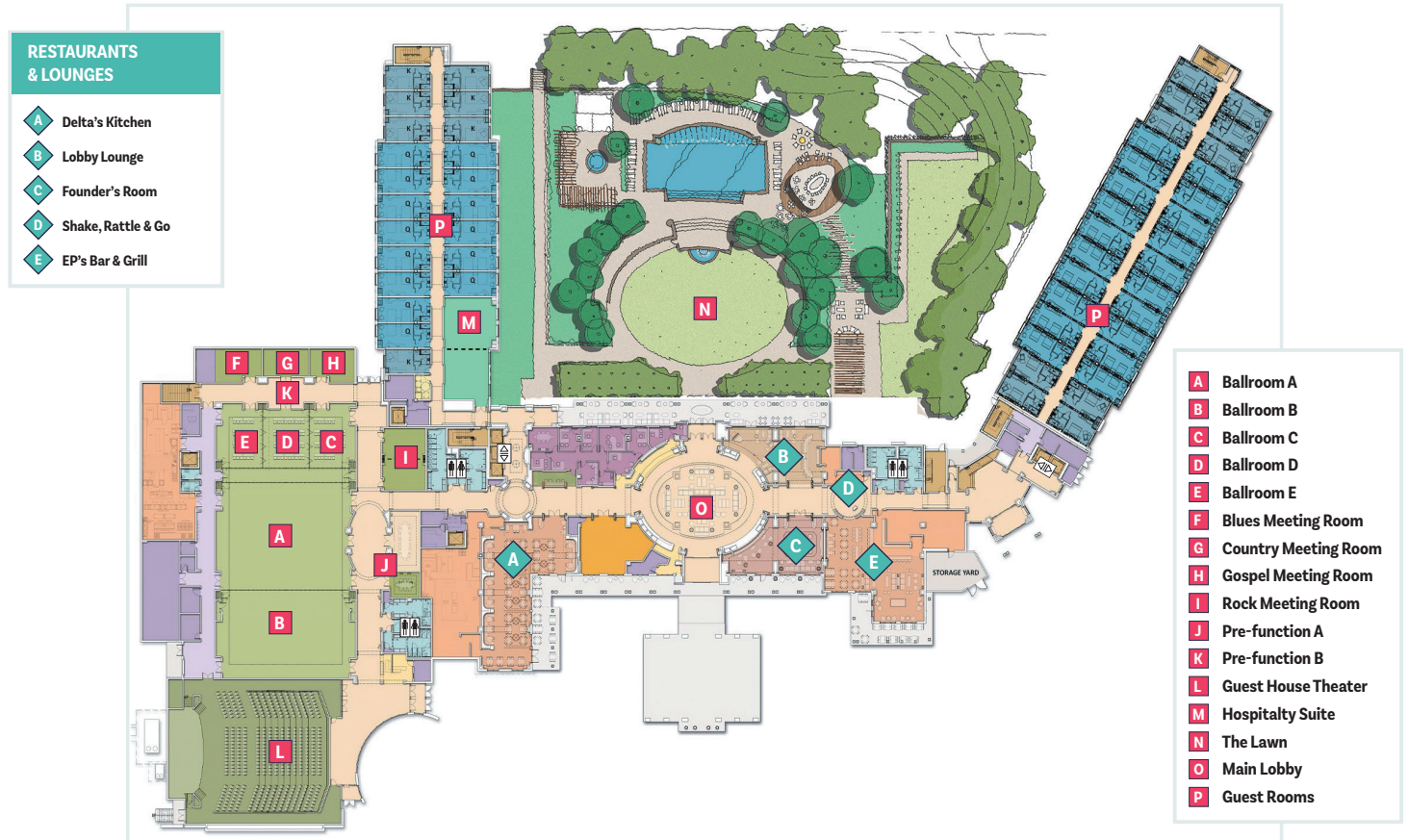

| The Guest House at Graceland | Sq. Ft. | Ceiling Ht. | Theater | Classroom | U-Shape | Conference | RD 8 | RD 10 | Exhibits (10x10) | Reception |
|------------------------------|---------|-------------|---------|-----------|---------|------------|------|-------|------------------|-----------|
| <b>Grand Ballroom (Full)</b> | 10,681  | 17 FT       | 1,200   | 650       | -       | -          | 570  | 720   | 60               | 1,100     |
| <b>Ballroom A</b>            | 4,578   | 17 FT       | 530     | 270       | 50      | 60         | 224  | 280   | 30               | 500       |
| <b>Ballroom A &amp; CDE</b>  | 7,503   | 17 FT       | 836     | 430       | -       | -          | 360  | 450   | 45               | 780       |
| <b>Ballroom A &amp; B</b>    | 7,682   | 17 FT       | 880     | 450       | -       | -          | 384  | 480   | 45               | 810       |
| <b>Ballroom B</b>            | 3,104   | 17 FT       | 350     | 180       | 40      | 50         | 144  | 180   | 15               | 310       |
| <b>Ballroom CDE</b>          | 2,926   | 17 FT       | 306     | 160       | 40      | 50         | 128  | 160   | 15               | 270       |
| <b>Ballroom C</b>            | 964     | 17 FT       | 75      | 48        | 24      | 28         | 48   | 60    | -                | 70        |
| <b>Ballroom D</b>            | 1,044   | 17 FT       | 80      | 54        | 24      | 28         | 48   | 60    | -                | 80        |
| <b>Ballroom E</b>            | 918     | 17 FT       | 70      | 42        | 24      | 28         | 40   | 50    | -                | 70        |
| <b>Ballroom C &amp; D</b>    | 2,008   | 17 FT       | 155     | 102       | 32      | 36         | 96   | 120   | -                | 150       |
| <b>Ballroom D &amp; E</b>    | 1,962   | 17 FT       | 150     | 98        | 32      | 36         | 96   | 120   | -                | 150       |
| <b>Blues Meeting Room</b>    | 438     | 10 FT       | 30      | 14        | 14      | 16         | 16   | 20    | -                | 20        |
| <b>Country Meeting Room</b>  | 403     | 10 FT       | -       | -         | -       | 12         | -    | -     | -                | -         |
| <b>Gospel Meeting Room</b>   | 419     | 10 FT       | 30      | 14        | 14      | 16         | 16   | 20    | -                | 20        |
| <b>Rock Meeting Room</b>     | 770     | 13 FT       | 60      | 40        | 20      | 24         | 40   | 50    | -                | 50        |
| <b>Pre-function A</b>        | 3,124   | 17 FT       | -       | -         | -       | -          | -    | -     | 12               | 200       |
| <b>Pre-function B</b>        | 1,001   | 17 FT       | -       | -         | -       | -          | -    | -     | 10               | 100       |
| <b>Guest House Theater</b>   | 7,345   | 20 FT       | 464     | 464       | -       | -          | -    | -     | -                | -         |
| <b>The Lawn</b>              | -       | -           | 250     | -         | -       | -          | 320  | 400   | -                | 500       |
| <b>Founders Room</b>         | 900     | 17FT        | -       | -         | 15      | 18         | 16   | 20    | -                | 70        |

# Graceland Exhibition Center

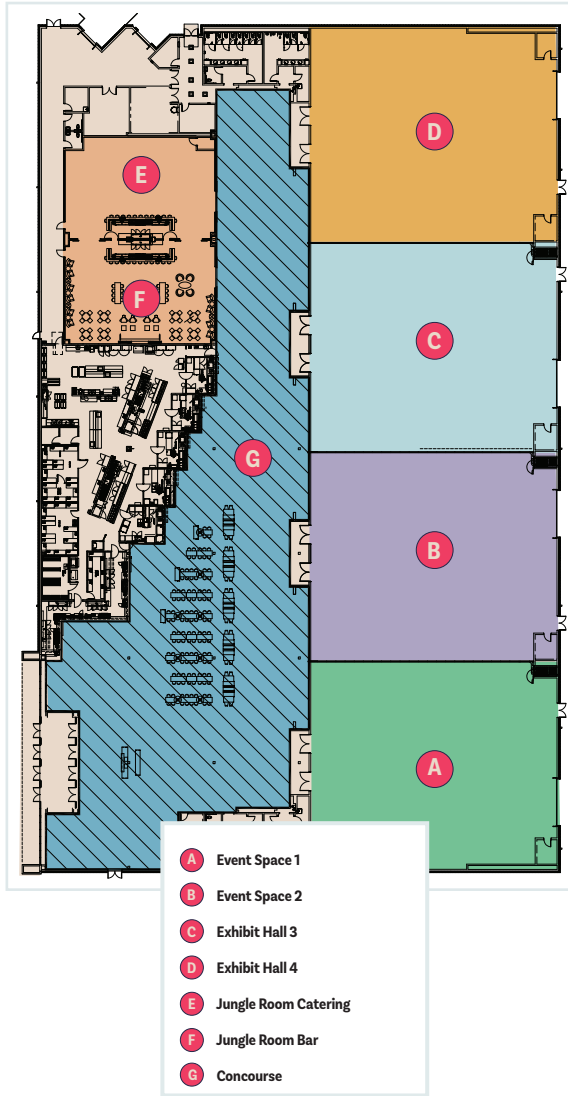

# Elvis Presley's Memphis



| Graceland Exhibition Center | Sq. Ft. | Ceiling Ht. | Theater | Classroom | U-Shape | Conference | RD 8 | RD 10* | Exhibits (10x10) | Reception |
|-----------------------------|---------|-------------|---------|-----------|---------|------------|------|--------|------------------|-----------|
| Event Space 1               | 8,780   | 30 FT       | 940     | 560       | -       | -          | 448  | 560    | 50               | 850       |
| Event Space 2               | 9,340   | 30 FT       | 980     | 590       | -       | -          | 480  | 600    | 55               | 920       |
| Exhibit Hall 3              | 9,452   | 30 FT       | 980     | 590       | -       | -          | 480  | 600    | 55               | 920       |
| Exhibit Hall 4              | 9,070   | 30 FT       | 950     | 560       | -       | -          | 448  | 560    | 50               | 850       |
| Jungle Room Catering        | 2,442   | 15 FT       | 250     | 110       | 25      | 30         | 96   | 120    | 10               | 130       |
| Jungle Room Bar             | 2,442   | 15 FT       | -       | -         | -       | -          | -    | -      | -                | 130       |
| Concourse                   | 18,650  | 30 FT       | -       | -         | -       | -          | 720  | 900    | -                | 1,600     |

| Elvis Presley's Memphis | Sq. Ft. | Ceiling Ht. | Theater | Classroom* | U-Shape* | Conference | RD 8 | RD 10* | Exhibits (10x10) | Reception |
|-------------------------|---------|-------------|---------|------------|----------|------------|------|--------|------------------|-----------|
| Soundstage (Full)       | 14,115  | 30 FT       | 1,650   | 850        | -        | -          | 720  | 900    | 80               | 1,600     |
| Soundstage (Half)       | 8,394   | 30 FT       | 940     | 520        | -        | -          | 410  | 520    | 60               | 900       |
| Lightning Lounge        | 6,190   | 18 FT       | 650     | 340        | -        | -          | 264  | 380    | -                | 580       |
| Presley Cycles          | 7,070   | 18 FT       | -       | -          | -        | -          | -    | -      | -                | 680       |
| Presley Motors          | 9,300   | 24 FT       | 350     | -          | -        | -          | 280  | 350    | -                | 920       |

\* Tables must be rented